

VECTOR

VEC.C.D.L.2.M3.G



SPECIFICATION TEXT

SURFACE VECTOR, MAINTAINED EMERGENCY EXIT SIGN WITH DIRECTIONAL PICTOGRAM FOR RECOGNITION UPTO 30M, LED LIGHT SOURCE, BATTERY TO GIVE FULL OPERATION IN THE EVENT OF MAINS FAILURE FOR 3 HOURS, 24HR CHARGE TIME. ALUMINIUM HOUSING FINISHED SILVER GREY. DIMENSIONS: (LXWXH) 315 X 48 X 243MM (ORDER LEGEND SEPERATELY)

PRODUCT IMAGE



TECHNICAL DETAILS

- Light Distribution: Legend
- Light Source: LED
- Connected Load: 2W
- EM State: Maintained
- Ingress Protection: IP41
- Charge time: 24hrs
- Options: Suspended (S) & Wall (W) mount available

DIMENSIONAL DETAIL

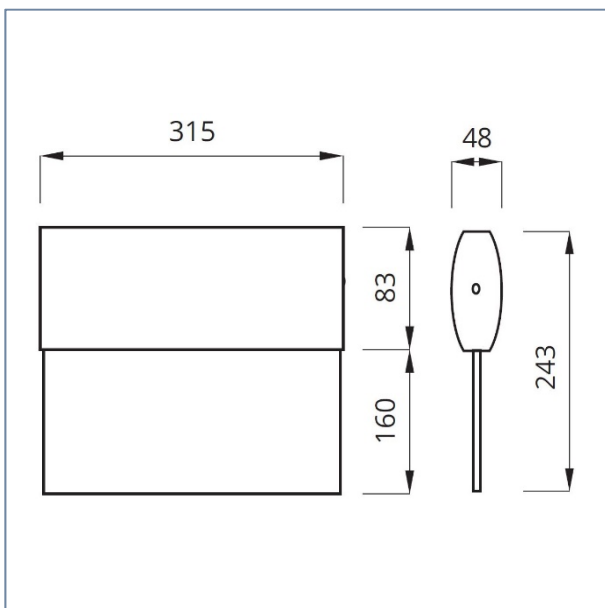

ADDITIONAL DETAILS

